



DARC MONO

SPECIFICATIONS SHEET

10/22

SPECIFICATIONS SHEET 10/22

DONOR VEHICLE / BASISFAHRZEUG

MAKE / MARKE	IVECO
MODEL / MODELL	2023 DAILY 4X4 70S18HA8
ENGINE / MOTOR	2.998 CM ³ / 4 CYLINDER / 132KW (180PS) / 430NM
EMMISSION STANDARD / ABGASNORM	EURO VI
TRANSMISSION / GETRIEBE	8-GEAR CONVERTER AUTOMATIC
WHEELSBASE / RADSTAND	3780MM
ADMISSIBLE TOTAL WEIGHT / ZULÄSSIGES GESAMTGEWICHT	6600KG / 14550LBS
VEHICLE DIMENSIONS [L X W X H] / FAHRZEUGMASSE [L X B X H]	6700MM X 2500MM X 3300MM

CHASSIS / FAHRGESTELL

SUSPENSION / STOSSDAMPFER	KW AUTOMOTIVE FULLY ADAPTIVE SYSTEM
WHEELS / FELGEN	DARC MONO 17" X 9,5" REINFORCED CAST ALUMINUM
TIRES / REIFEN	LAKESEA TRACKAMSTER M/S 37X12.50R17 LOAD INDEX 131N
LADDER FRAME / LEITERRAHMEN	DARC MONO CUSTOM STEEL SUBFRAME
UNDERBODY PROTECTION / UNTERBODENSCHUTZ	DARC MONO CARBON FIBER
BULL BARS / BULLFÄNGER	DARC MONO 60MM TUBING COATED IN BLACK POWDER
WINCH / SEILWINDE	WARN ZEON 12
ROOF RACK / DACHTRÄGER	DARC MONO CARBON FIBER

SPECIFICATIONS SHEET 10/22

CABIN / WOHNKABINE

OUTER DIMENSIONS [L X W X H] / AUSSENMASSE [L X B X H]	4200MM X 2200MM X 2200MM
INNER DIMENSIONS [L X W X H] / INNENMASSE [B X H]	3900MM X 2000MM X 2050MM
MATERIAL / MATERIAL	CARBON FIBER SANDWICH MONOCOQUE
NET WEIGHT / NETTOGEWICHT	550KG / 1210LBS
DRIVER CABIN HATCH [W X H] / FAHRERHAUSLUKE [B X H]	500MM X 1100MM
MAIN DOOR [W X H] / EINSTIEGSTÜR [B X H]	610MM X 1900MM
REAR WINDOW [W X H] / HECKFENSTER [B X H]	1500MM X 600MM
SIDE WINDOW (2X) [W X H] / SEITENFENSTER (2X) [B X H]	1100MM X 600MM
KITCHEN WINDOW [W X H] / KÜCHENFENSTER [B X H]	900MM X 600MM
BATHROOM WINDOW [W X H] / BADFENSTER [B X H]	350MM X 600MM
ROOF WINDOW [L X W] / DACHFENSTER [L X B]	2100MM X 630MM

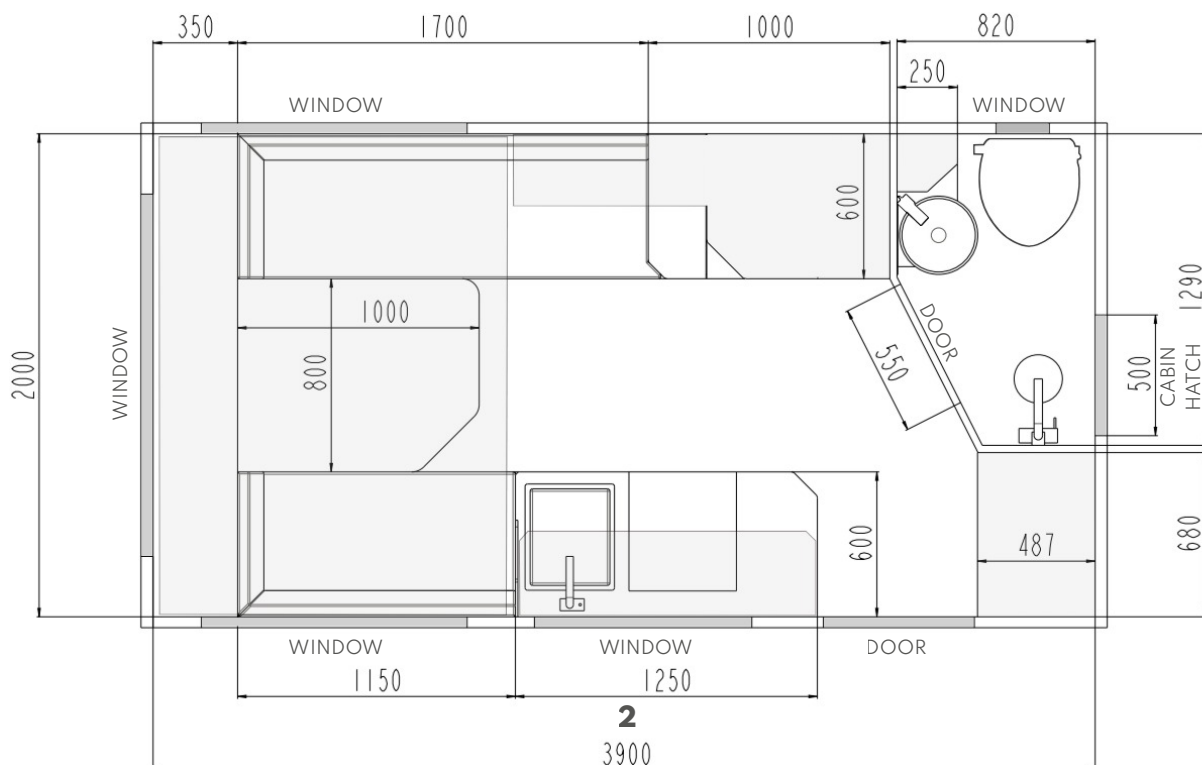

SPECIFICATIONS SHEET 10/22

INTERIOR / INNENRAUM

SLEEPING CAPACITY / SCHLAFPLATZE	2
SEATING CAPACITY / SITZPLÄTZE	5
BATHROOM SPACE / BADFLÄCHE	0,95 M ²
SHOWER SPACE / DUSCHFLÄCHE	0,45 M ²
BED DIMENSIONS [L X W] / BETTMASSE [L X B]	1900MM X 1400MM
TABLE DIMENSIONS [L X W X H] / TISCHMASSE [L X B X H]	1000MM X 800MM X 760MM
KITCHEN DIMENSIONS [L X W X H] / KÜCHENMASSE [L X B X H]	1200MM X 600MM X 860MM
STORAGE VOLUME / STAURAUMLVOLUMEN	2600L
HEATER / HEIZUNG	TRUMA COMBI D6E
AIR CONDITIONING / KLIMAAANLAGE	TRUMA SAPHIR COMPACT
FRIDGE & FREEZER/ KÜHL- & GEFRIERSCHRANK	DOMETIC RC 10.4T 90L
OUTSIDE BBQ GRILL / AUSSENGRILL	ENDERS URBAN PRO
STOVE & OVEN / HERD & OFEN	THETFORD TRIPLEX
TOILETTE / TOILETTE	NATURES HEAD
WATER PROCESSING UNIT / WASSERFILTER	FAMOUS WATER
BEAMER / BEAMER	VIEWSONIC M2
AUDIO SYSTEM / AUDIOANLAGE	JEHNERT AUDIO CUSTOM 5.1 SYSTEM
LIGHTING / BELEUCHTUNG	FULLY INTEGRATED LED LIGHTING
FLOORING / BODENBELAG	POLYFLOOR CAOUTCHOUC

SPECIFICATIONS SHEET 10/22

CAPACITIES & ENERGY / KAPAZITÄTEN & ENERGIE

DIESEL FUEL / DIESEL	190L
AD BLUE / AD BLUE	20L
FRESH WATER / FRISCHWASSER	230L
GREY WATER (RECOMMENDED) / GRAUWASSER (EMPFOHLEN)	45L
GAS (RECOMMENDED) / GAS (EMPFOHLEN)	40L
HOT WATER BOILER / WARMWASSERSPEICHER	10L
BATTERY CAPACITY / BATTERIEKAPAZITÄT	416 AH @ 24V (≈832AH @ 12V) ≈ 8KW/H
BATTERY TYPE / BATTERIETYP	LIFEPO4
BATTERY MODEL / BATTERIEMODELL	DARC MONO CELL
INVERTER / WECHSELRICHTER	MASTERVOLT 3000W
SOLAR PANEL / SOLARPANEL	400W MODULE
CONTROL UNIT / KONTROLLPANEL	MASTERVOLT